

Note?

1. edge dist.
2. Hardware:
3. bag lock?
4. Leather t
5. When you
the holes c
6. Made one
7. DWG docu

ance 4MM;
?buckle closures inner diameter is 3.2CM,bag lock,screw,stub.
'length 3.2CM,the top maximum width 2.2CM
hickness 2-2.5MM, vegetable tanned leather?

punch holes, please match the pattern on your leather, make sure
are neat.

: more as gift to you,you can adjust the scale as you can.
ument is the original document ^ ^ .



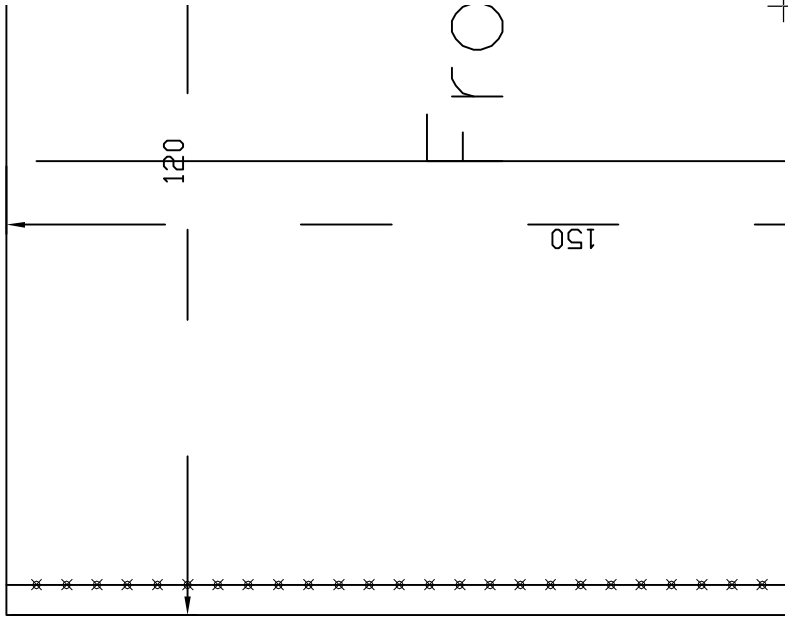
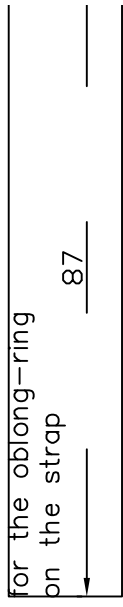
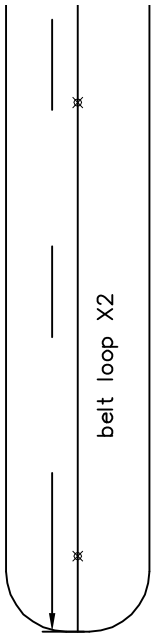

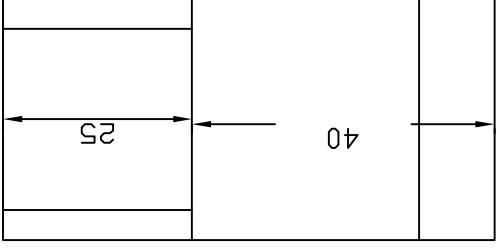
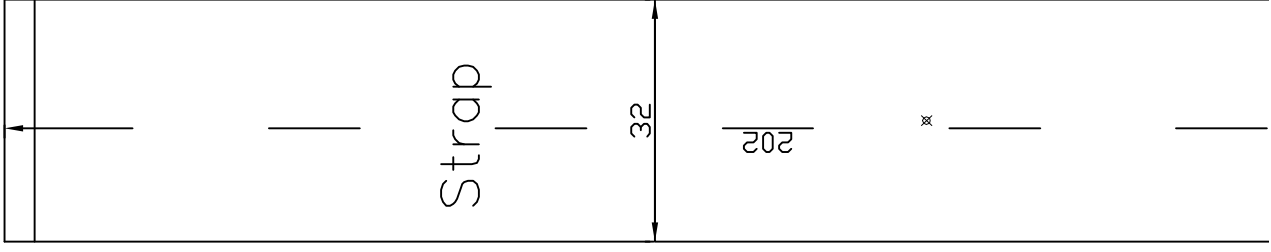
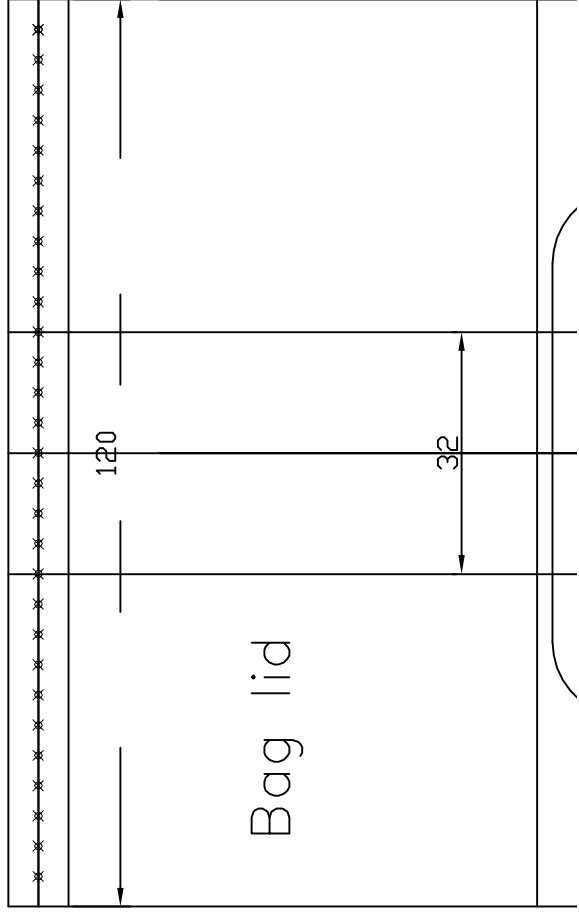
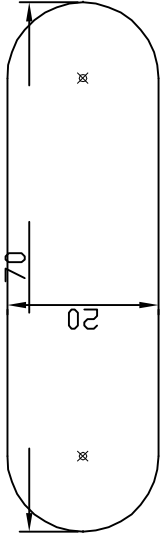
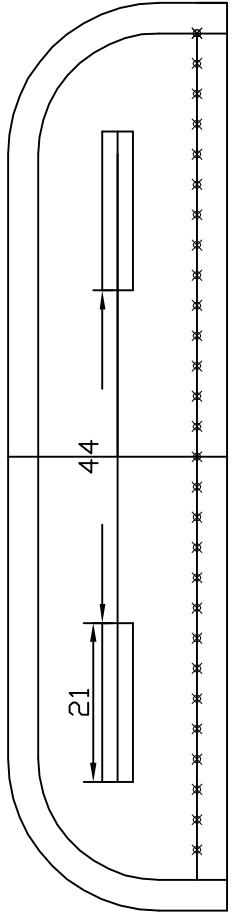
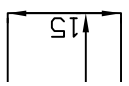
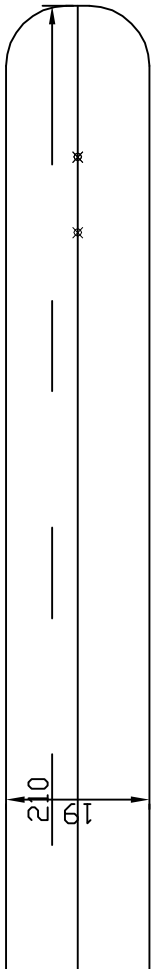

bag lock connection leather, fold on the 25mm end, punch a oval hole in the middle for the buckle closure and oblong-ring

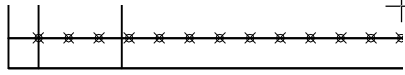

int

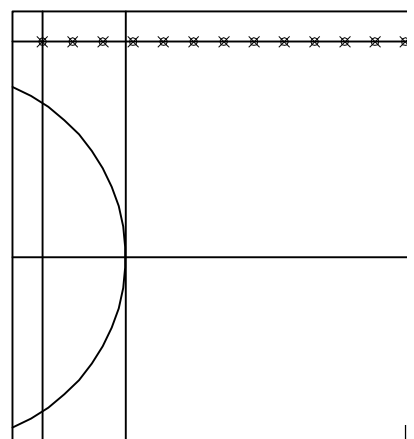

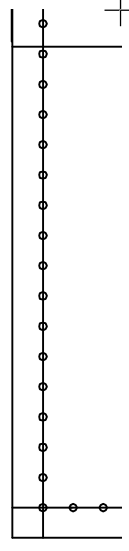
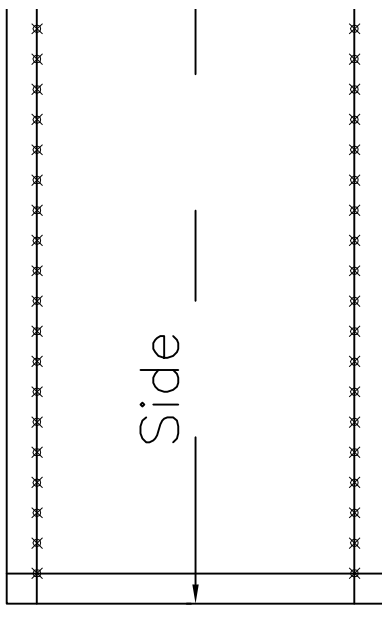
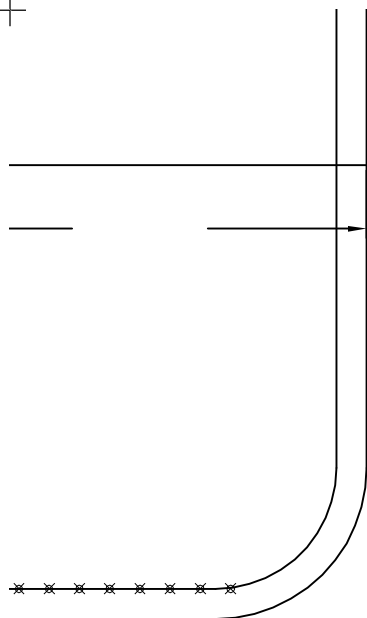

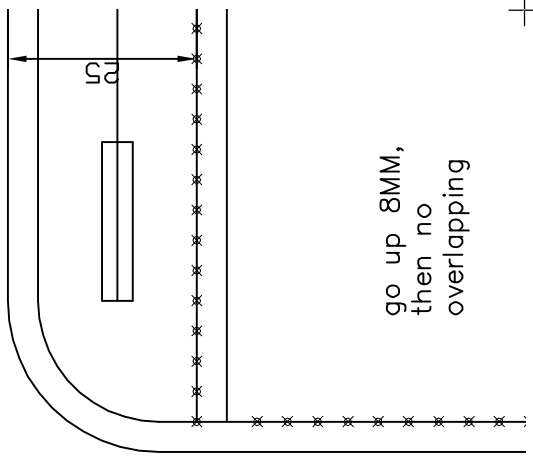
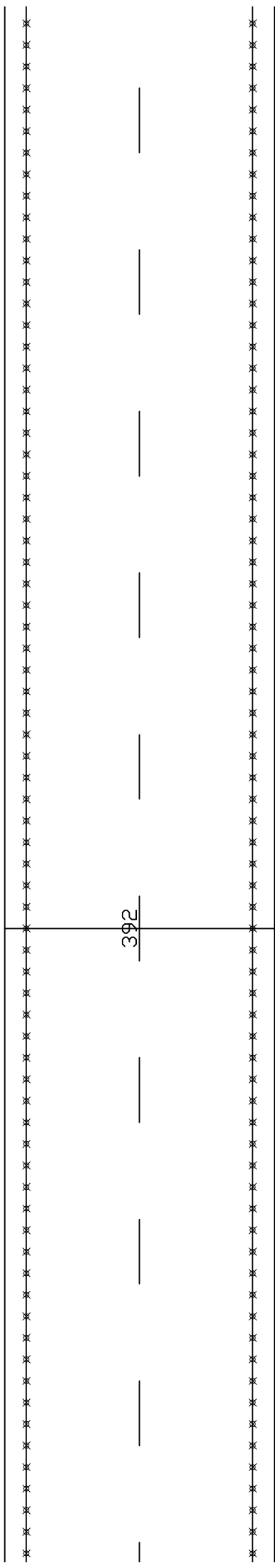
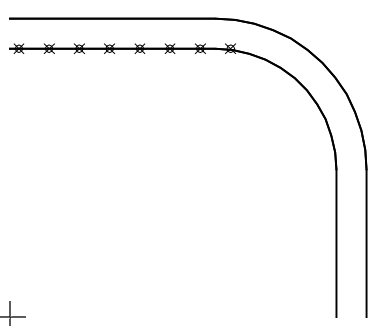
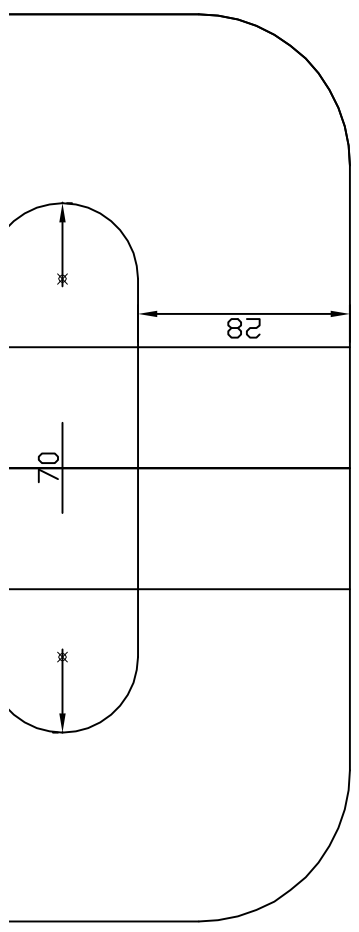
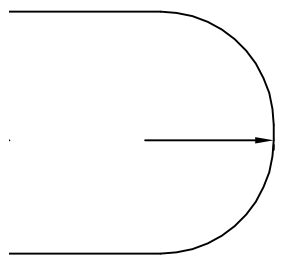
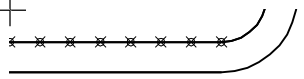

go up 8MM,
then no
overlapping

